

SCHUBERT MORTUARY BOOK
(Dec. 11, 1912 - Oct. 14, 1924)

Date _____

No. _____

NAME OF DECEASED Mrs. ELMER W. HICKS

Charge to _____

Order given by _____
How secured _____

Date of Funeral _____

Place of Death _____

Funeral Services at _____

Time of Funeral Service _____

Clergyman _____

Physician _____

Number of Burial Certificate _____

Cause of Death _____

Date of Death _____

Date of Birth _____

Occupation _____

Single or Married _____ Religion _____

Aged _____ years _____ months _____ days

Body to be shipped _____

Styl of Grave Vault _____

Interment at _____

Lot or Grave No. _____ Sec No. _____

Other Information

no other info

Date on proceeding page

OCT 31 (1917)

Date on following page

NOV 28 1917

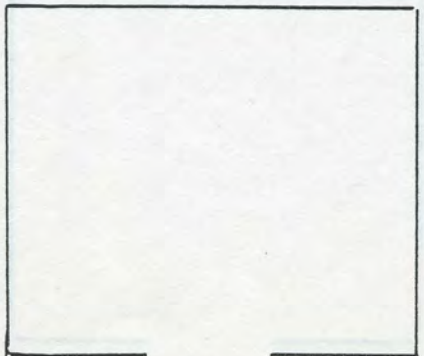

- 1 _____
- 2 _____
- 3 _____
- 4 _____
- 5 _____
- 6 _____

SCHUBERT MORTUARY BOOK
(Dec. 11, 1912 - Oct. 14, 1924)

✓ 147

Date Nov 28 1917

No. _____

NAME OF DECEASED Mrs. W^m BELK

Charge to _____

Other Information

Order given by _____

How secured _____

Date of Funeral _____

Place of Death _____

Funeral Services at _____

Time of Funeral Service _____

Clergyman _____

Physician _____

Number of Burial Certificate _____

Cause of Death _____

Date of Death _____

Date of Birth _____

Occupation _____

Single or Married _____

Religion _____

Aged _____ years _____ months _____ days

Body to be shipped _____

Styl of Grave Vault _____

Interment at VINLAND Cem.

Lot or Grave No. _____ Sec No. _____

That's all the info

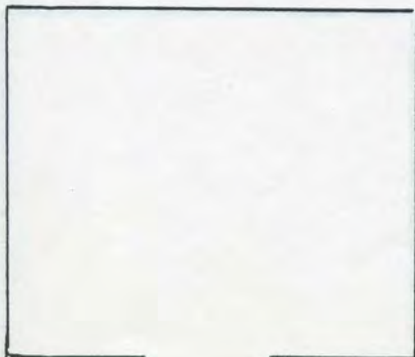

- 1 _____
- 2 _____
- 3 _____
- 4 _____
- 5 _____
- 6 _____

SCHUBERT MORTUARY BOOK
(Dec. 11, 1912 - Oct. 14, 1924)

Date Dec 12 1917

No. _____

NAME OF DECEASED Mrs DURST

Charge to GUS ZIESENIS

Other Information

Order given by _____
How secured _____

no other info

Date of Funeral _____

Place of Death _____

Funeral Services at _____

Time of Funeral Service _____

Clergyman _____

Physician _____

Number of Burial Certificate _____

Cause of Death _____

Date of Death _____

Date of Birth _____

Occupation _____

Single or Married _____ Religion _____

Aged _____ years _____ months _____ days

Body to be shipped _____

Styl of Grave Vault _____

Interment at _____

Lot or Grave No. _____ Sec No. _____

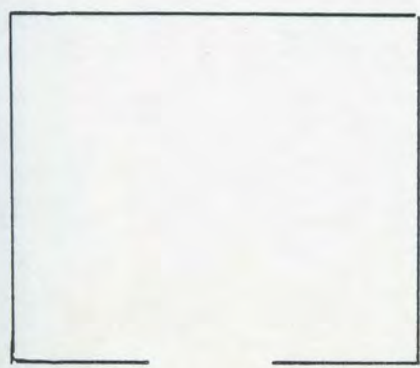

- 1 _____
- 2 _____
- 3 _____
- 4 _____
- 5 _____
- 6 _____

SCHUBERT MORTUARY BOOK
(Dec. 11, 1912 - Oct. 14, 1924)

Date JAN 15 1918

No. _____

NAME OF DECEASED EDWARD C. WARREN

Charge to _____

Other Information

Order given by _____
How secured _____

No other info.

Date of Funeral _____

Place of Death _____

Funeral Services at _____

Time of Funeral Service _____

Clergyman _____

Physician _____

Number of Burial Certificate _____

Cause of Death _____

Date of Death _____

Date of Birth _____

Occupation _____

Single or Married _____ Religion _____

Aged _____ years _____ months _____ days

Body to be shipped _____

Styl of Grave Vault _____

Interment at _____

Lot or Grave No. _____ Sec No. _____

Douglas County Genealogical Society

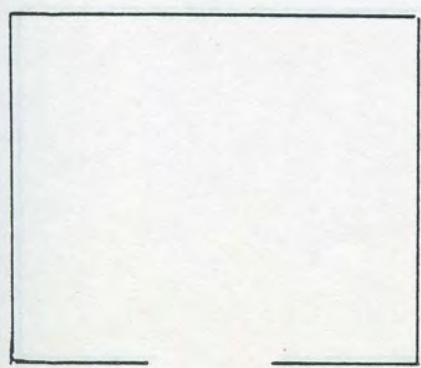

- 1 _____
- 2 _____
- 3 _____
- 4 _____
- 5 _____
- 6 _____

SCHUBERT MORTUARY BOOK
(Dec. 11, 1912 - Oct. 14, 1924)

No. _____

Date _____

NAME OF DECEASED Mrs. C. SISCOE

Charge to _____

Other Information

Order given by _____

How secured _____

NO other info

Date of Funeral _____

INDEX Lists: SISCOE, Mrs C. F.

Place of Death _____

Funeral Services at _____

Time of Funeral Service _____

Proceeding page date

Clergyman _____

JAN 15, 1918

Physician _____

No date on next

Number of Burial Certificate _____

Two pages -

Cause of Death _____

date on page #153

Date of Death _____

Mar 14, 1918

Date of Birth _____

Occupation _____

Single or Married _____

Religion _____

Aged _____ years _____ months _____ days

Body to be shipped _____

Styl of Grave Vault _____

Interment at _____

Lot or Grave No. _____ Sec No. _____

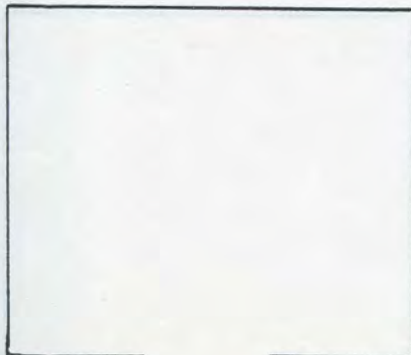

- 1 _____
- 2 _____
- 3 _____
- 4 _____
- 5 _____
- 6 _____

SCHUBERT MORTUARY BOOK
(Dec. 11, 1912 - Oct. 14, 1924)

Date _____

No. _____

NAME OF DECEASED Mrs CHAS SCHURICHT

Charge to _____

Other Information

Order given by _____

How secured _____

Date of Funeral _____

Place of Death _____

Funeral Services at _____

Time of Funeral Service _____

Clergyman _____

Physician _____

Number of Burial Certificate _____

Cause of Death _____

Date of Death _____

Date of Birth _____

Occupation _____

Single or Married _____ Religion _____

Aged _____ years _____ months _____ days

Body to be shipped _____

Styl of Grave Vault _____

Interment at _____

Lot or Grave No. _____ Sec No. _____

Thats all

*Date between
JAN 15, 1918 -
MAR 14 1918*

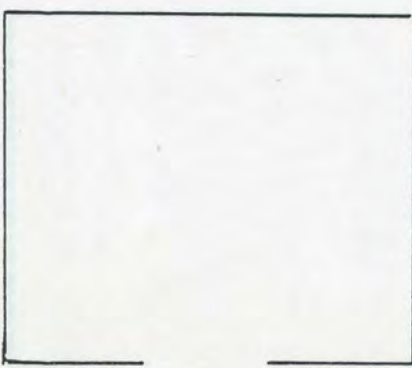

- 1 _____
- 2 _____
- 3 _____
- 4 _____
- 5 _____
- 6 _____

SCHUBERT MORTUARY BOOK
(Dec. 11, 1912 - Oct. 14, 1924)

Date no date

No. _____

NAME OF DECEASED AUG MYER

Charge to _____

Other Information

Order given by _____
How secured _____

Date of Funeral Mar 17

Place of Death 28th St at Clearfield

Funeral Services at Clearfield

Time of Funeral Service 2:30

Clergyman Shrock

Physician Green

Number of Burial Certificate _____

Cause of Death Cerebral Hemorrhage

Date of Death MAR 14 1918

Date of Birth MAR 13 1849

Occupation Ret Stone Mason

Single or Married Married

Religion _____

Aged 77 years 11 months 2 days

Body to be shipped _____

Styl of Grave Vault _____

Interment at Clearfield

Lot or Grave No. _____ Sec No. _____

(Date between
JAN 15, 1918 -
MAR 14 1918)

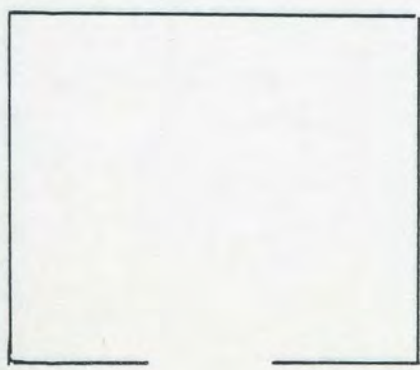

- 1 _____
- 2 _____
- 3 _____
- 4 _____
- 5 _____
- 6 _____

SCHUBERT MORTUARY BOCK
(Dec. 11, 1912 - Oct. 14, 1924)

Date Mar 14 1918

No. _____

NAME OF DECEASED NICHALOUS BAKER

Charge to Mrs BAKER

Other Information

Order given by _____
How secured _____

Date of Funeral Mar 17

Place of Death 2 1/4 Mi SE of Clearfield

Funeral Services at Clearfield

Time of Funeral Service 2 P.M.

Clergyman Shrenk

Physician Greer

Number of Burial Certificate _____

Cause of Death Creeping Paralysis

Date of Death MAR 14 1918

Date of Birth MAY 12 1840

Occupation Ret STONE MASON

Single or Married Married Religion _____

Aged 77 years 10 months 2 days

Body to be shipped _____

Styl of Grave Vault _____

Interment at Clearfield Cem.

Lot or Grave No. _____ Sec No. _____

Flowers:
Wm SELZER
Anna SHULZ
Telegram for Wm SELZER

Pd on acct.
Mrs. NICHOLAS BAKER
(NICHOLAS spelled different)

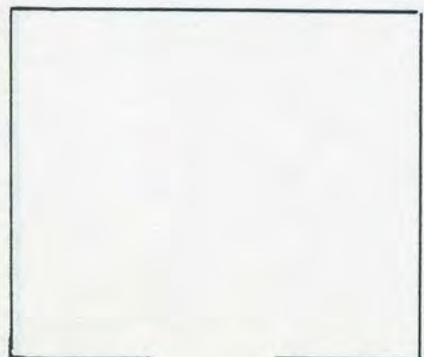

- 1 _____
- 2 _____
- 3 _____
- 4 _____
- 5 _____
- 6 _____

SCHUBERT MORTUARY BOOK
(Dec. 11, 1912 - Oct. 14, 1924)

154

Date MAR 27 1918

No. _____

NAME OF DECEASED MRS. JOHANNA ZIESENIS

Charge to CHAS ZIESENIS

Other Information

Order given by _____
How secured _____

Date of Funeral MAR 29

Place of Death Eudora

Funeral Services at Lutheran Church

Time of Funeral Service 3:00 P.M.

Clergyman STOERKER

Physician J. G. Lee

Number of Burial Certificate _____

Cause of Death OLD AGE

Date of Death Mar 27 1918

Date of Birth MAY 9 1932

Occupation Housewife

Single or Married widow Religion _____

Aged 85 years 10 months 18 days

Body to be shipped _____

Styl of Grave Vault _____

Interment at Eudora Cem.

Lot or Grave No. _____ Sec No. _____

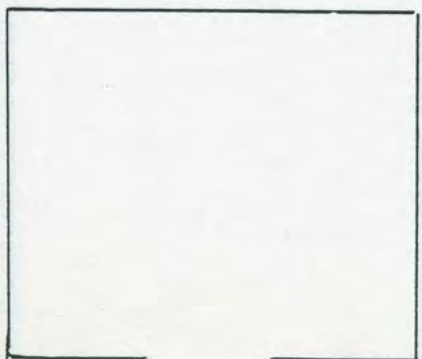

- 1 _____
- 2 _____
- 3 _____
- 4 _____
- 5 _____
- 6 _____

SCHUBERT MORTUARY BOOK
(Dec. 11, 1912 - Oct. 14, 1924)

Date MAR 29 1918

✓ 15-

No. _____

NAME OF DECEASED NEMIAN LOVELACE

Charge to S. V. CARR

Other Information

Order given by _____

How secured _____

Date of Funeral Mar 29 1918

Place of Death Winfield Kans

Funeral Services at Cemetary

Time of Funeral Service 10 a.m.

Clergyman Geo. SHRENK

Physician F. C. CAVE

Number of Burial Certificate _____

Cause of Death Diabetis

Date of Death MAR 27 1918

Date of Birth _____

Occupation _____

Single or Married _____

Religion _____

Aged 50 years _____ months _____ days

Body to be shipped _____

Styl of Grave Vault _____

Interment at Eudora Cem.

Lot or Grave No. 40 Sec No. 3

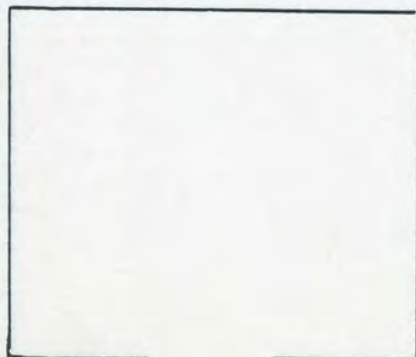

- 1 _____
- 2 _____
- 3 _____
- 4 _____
- 5 _____
- 6 _____

SCHUBERT MORTUARY BOOK
(Dec. 11, 1912 - Oct. 14, 1924)

Date Apr. 1 1918

No. _____

NAME OF DECEASED MATHEW J. FORTNER

Charge to Mrs. LULA FORTNER

Other Information

Order given by _____
How secured _____

Date of Funeral Apr 1 1918

Place of Death Tepeka S. Fe Hospital

Funeral Services at Baptist Church

Time of Funeral Service 11 a.m.

Clergyman _____

Physician J. D. Freeman

Number of Burial Certificate _____

Cause of Death Lobar Pneumonia

Date of Death Mar 29 1918

Date of Birth _____

Occupation Porter on Train

Single or Married _____ Religion _____

Aged 45 years _____ months _____ days

Body to be shipped _____

Styl of Grave Vault _____

Interment at Eudora Cem.

Lot or Grave No. 40 Sec No. 3

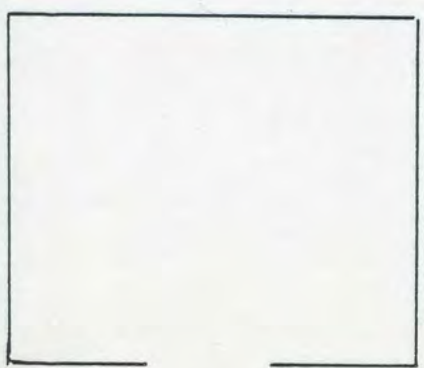

- 1 _____
- 2 _____
- 3 _____
- 4 _____
- 5 _____
- 6 _____

SCHUBERT MORTUARY BOOK
(Dec. 11, 1912 - Oct. 14, 1924)

Date Apr 7 1918

No. _____

NAME OF DECEASED HIRAM NOWLIN

Charge to _____

Other Information

Order given by JOSIAH WESTON
How secured _____

Date of Funeral Apr 7

Place of Death Marshall Mich.

Funeral Services at Friends Prarie Centre

Time of Funeral Service 11 a.m.

Clergyman _____

Physician W. H. Niles

Number of Burial Certicate _____

Cause of Death Carcinoma of Stomach

Date of Death Apr 3 1918

Date of Birth Oct 8 1824

Occupation Farmer

Single or Married Widow Religion _____

Aged 93 years 5 months 25 days

Body to be shipped _____

Styl of Grave Vault _____

Interment at Prarie Centre Cem.

Lot or Grave No. _____ Sec No. _____

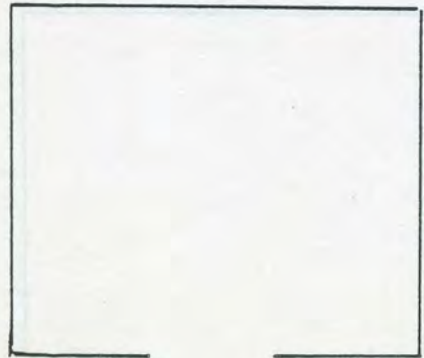

- 1 _____
- 2 _____
- 3 _____
- 4 _____
- 5 _____
- 6 _____

SCHUBERT MORTUARY BOOK
(Dec. 11, 1912 - Oct. 14, 1924)

Date JUNE 24 1918

No. _____

NAME OF DECEASED Mrs MARIE WICHMANN

Charge to H. C. WICHMANN

Order given by _____
How secured _____

Other Information

wife of H.C. WICHMANN

Date of Funeral June 26

Place of Death Eudora

Funeral Services at Lutheran

Time of Funeral Service 3 P.M.

Clergyman Fred STOERKER

Physician J. G. Lee

Number of Burial Certificate _____

Cause of Death Childbirth

Date of Death June 24

Date of Birth Mar 19 1876

Occupation Housewife

Single or Married Married Religion _____

Aged 42 years 3 months 5 days

Body to be shipped _____

Styl of Grave Vault _____

Interment at Eudora Cem.

Lot or Grave No. _____ Sec No. _____

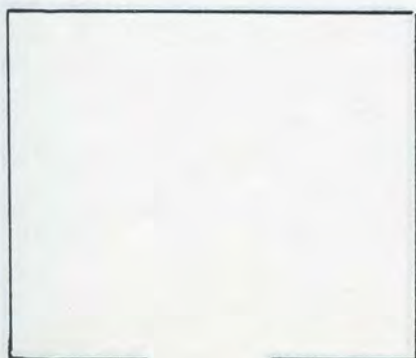

- 1 _____
- 2 _____
- 3 _____
- 4 _____
- 5 _____
- 6 _____

SCHUBERT MORTUARY BOOK
(Dec. 11, 1912 - Oct. 14, 1924)

Date June 24 1918

No. _____

NAME OF DECEASED HERBERT WICHMANN

Charge to H. C. WICHMANN

Order given by _____
How secured _____

Other Information

Son of H. C. WICHMANN

Date of Funeral June 26

Place of Death Eudora

Funeral Services at Lutheran

Time of Funeral Service 3 P.M.

Clergyman Stoerker

Physician J. G. Lee

Number of Burial Certificate _____

Cause of Death Stillborn

Date of Death June 24 1918

Date of Birth June 24 1918

Occupation _____

Single or Married _____ Religion _____

Aged STILL BORN years _____ months _____ days

Body to be shipped _____

Styl of Grave Vault _____

Interment at Eudora Cem.

Lot or Grave No. _____ Sec No. _____

(in casket with mother)

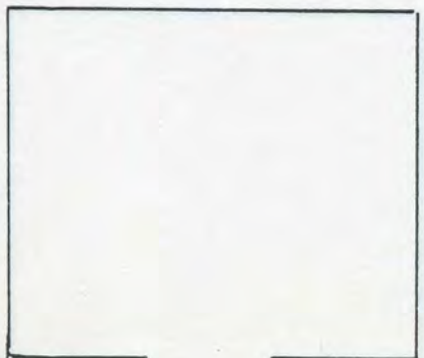

- 1 _____
- 2 _____
- 3 _____
- 4 _____
- 5 _____
- 6 _____

SCHUBERT MORTUARY BOCK
(Dec. 11, 1912 - Oct. 14, 1924)

Date July 7 1918

No. _____

NAME OF DECEASED Hy HARDIN

Charge to ELLEN CLARK

Other Information

Order given by _____
How secured _____

Date of Funeral July 7

Place of Death Kans City Mo.

Funeral Services at Methodist

Time of Funeral Service 2 PM

Clergyman Pryor

Physician _____

Number of Burial Certificate _____

Cause of Death acute dialation of heart

Date of Death June 30

Date of Birth _____

Occupation _____

Single or Married _____ Religion _____

Aged 32 years _____ months _____ days

Body to be shipped _____

Styl of Grave Vault _____

Interment at South side Cem.

Lot or Grave No. _____ Sec No. _____

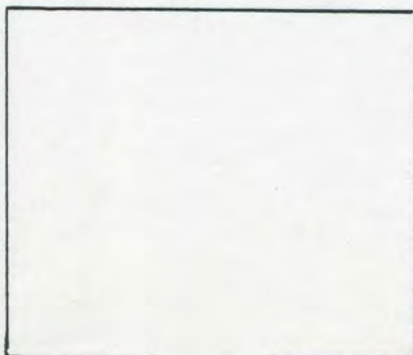

- 1 _____
- 2 _____
- 3 _____
- 4 _____
- 5 _____
- 6 _____

SCHUBERT MORTUARY BOOK
(Dec. 11, 1912 - Oct. 14, 1924)

Date Aug 11 1918

No. _____

NAME OF DECEASED Mrs HALE DUTTON

Charge to Mrs SARAH G. TERRELL

Other Information

Order given by _____

How secured _____

husband of Sarah G. Terrell

Date of Funeral Aug 16 1918

Place of Death Edison Ave. 278 St

Funeral Services at Central Ch. E.

Time of Funeral Service 3:30 P.M.

Clergyman Rev. J. H. Baker

Physician J. G. ...

Number of Burial Certificate _____

Cause of Death Heart failure

Date of Death Aug 11

Date of Birth July 2 1854

Occupation Farmer

Single or Married Married

Religion _____

Aged 62 years 1 months 9 days

Body to be shipped _____

Styl of Grave Vault _____

Interment at Edison

Lot or Grave No. _____ Sec No. _____

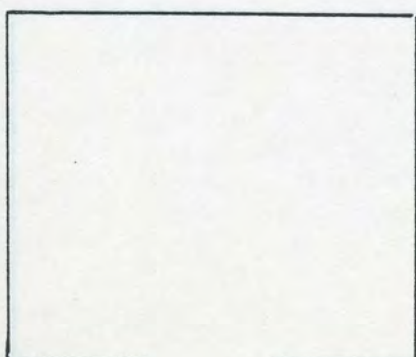

- 1 _____
- 2 _____
- 3 _____
- 4 _____
- 5 _____
- 6 _____

SCHUBERT MORTUARY BOOK
(Dec. 11, 1912 - Oct. 14, 1924)

✓162

Date Aug 14 1918

No. _____

NAME OF DECEASED CLARK TERRELL

Charge to Mrs SARAH C. TERRELL

Order given by _____
How secured _____

Other Information
husband of Sarah C. Terrell

Date of Funeral Aug 16 1918

Place of Death Eudora Twp 2³/₄ S.E.

Funeral Services at German M.E.

Time of Funeral Service 3 P.M.

Clergyman O.W. Zeidler - J.A.J. Bales

Physician J.G. Lee

Number of Burial Certificate _____

Cause of Death Hemorrhage from Kidney + Bladder

Date of Death Aug 14

Date of Birth July 5 1858

Occupation Farmer

Single or Married Married Religion _____

Aged 60 years 1 months 9 days

Body to be shipped _____

Styl of Grave Vault _____

Interment at Eudora Cem.

Lot or Grave No. _____ Sec No. _____

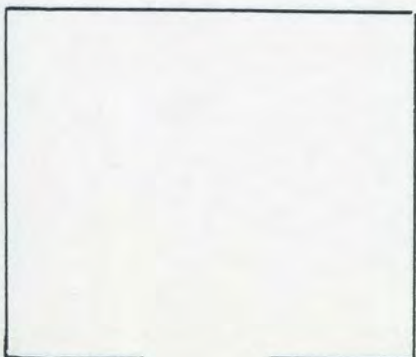

- 1 _____
- 2 _____
- 3 _____
- 4 _____
- 5 _____
- 6 _____

SCHUBERT MORTUARY BOOK
(Dec. 11, 1912 - Oct. 14, 1924)

Date Sept 1st 1918

No. _____

NAME OF DECEASED Geo. W. VALE

Charge to _____

Other Information

Order given by _____

How secured _____

Date of Funeral Sept 3 1918

Place of Death Fall Kans

Funeral Services at _____

Time of Funeral Service _____

Clergyman O. W. ZEIDLER

Physician H. J. MADISON Coroner

Number of Burial Certificate _____

Cause of Death Gun shot wood

Date of Death Sept 1 1918

Date of Birth _____

Occupation _____

Single or Married Married

Religion _____

Aged 52 years 6 months 9 days

Body to be shipped _____

Styl of Grave Vault _____

Interment at _____

Lot or Grave No. _____ Sec No. _____

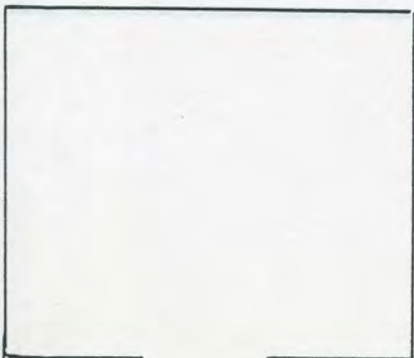

- 1 _____
- 2 _____
- 3 _____
- 4 _____
- 5 _____
- 6 _____

SCHUBERT MORTUARY BOOK
(Dec. 11, 1912 - Oct. 14, 1924)

✓164

Date Oct 6 1918

No. _____

NAME OF DECEASED EPHRAM JOHNSON

Charge to Mrs. HERNEL

Other Information

Order given by _____

How secured Cash

Bro. of Mrs. HERNEL

Date of Funeral Oct 6

Place of Death Eudora

Funeral Services at Methodist Church

Time of Funeral Service 2:30

Clergyman _____

Physician J. G. Lee

Number of Burial Certificate 12

Cause of Death Cerebral Hemmorrhage

Date of Death OCT 3

Date of Birth _____

Occupation Laborer

Single or Married _____

Religion _____

Aged 36 years _____ months _____ days

Body to be shipped _____

Styl of Grave Vault _____

Interment at Eudora Cem.

Lot or Grave No. _____ Sec No. _____

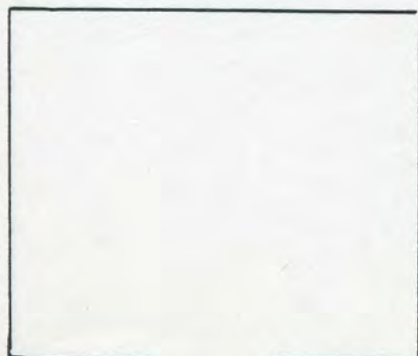

- 1 _____
- 2 _____
- 3 _____
- 4 _____
- 5 _____
- 6 _____

SCHUBERT MORTUARY BOCK
(Dec. 11, 1912 - Oct. 14, 1924)

Date _____

No. _____

NAME OF DECEASED GEO EDER

Charge to _____

Other Information

Order given by _____

How secured _____

Date of Funeral _____

Place of Death Camp Sherman

Funeral Services at Home

Time of Funeral Service _____

Clergyman Rev. Schmickler

Physician _____

Number of Burial Certificate _____

Cause of Death Lobar Pneumonia

Date of Death Oct 3rd 1918

Date of Birth _____

Occupation Soldier

Single or Married Single

Religion Catholic

Aged 28 years _____ months _____ days

Body to be shipped _____

Styl of Grave Vault _____

Interment at _____

Lot or Grave No. _____ Sec No. _____

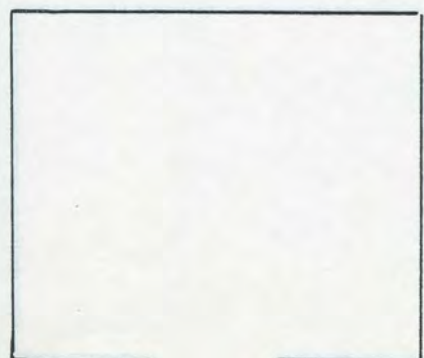

- 1 _____
- 2 _____
- 3 _____
- 4 _____
- 5 _____
- 6 _____

SCHUBERT MORTUARY BOOK
(Dec. 11, 1912 - Oct. 14, 1924)

Date _____

No. _____

NAME OF DECEASED FRED DECK

Charge to WILLIAM DECK

Other Information

Order given by _____

How secured _____

Date of Funeral _____

Place of Death Camp Sherman

Funeral Services at home

Time of Funeral Service 10 o'clock

Clergyman O. W. Zeidler

Physician _____

Number of Burial Certificate _____

Cause of Death Bronchial Pneumonia

Date of Death OCT 10, 1918

Date of Birth _____

Occupation Soldier

Single or Married Single Religion _____

Aged 20 years _____ months _____ days

Body to be shipped _____

Styl of Grave Vault _____

Interment at _____

Lot or Grave No. _____ Sec No. _____

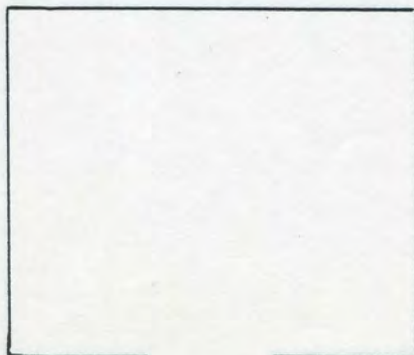

- 1 _____
- 2 _____
- 3 _____
- 4 _____
- 5 _____
- 6 _____

to date on this page
date on preceding page
OCT 10, 1918
date on following page
OCT 10, 1918

SCHUBERT MORTUARY BOCK
(Dec. 11, 1912 - Oct. 14, 1924)

167

Date _____

No. _____

NAME OF DECEASED CLARENCE LEFMANN

Charge to AUGUST LEFMANN

Other Information

Order given by _____

How secured _____

Date of Funeral _____

Place of Death Camp FUNSTON

Funeral Services at home

Time of Funeral Service 10 o'clock

Clergyman O. W. Zeidler

Physician _____

Number of Burial Certificate _____

Cause of Death Lobar Pneumonia

Date of Death _____

Date of Birth _____

Occupation Soldier

Single or Married Single

Religion Methodist

Aged 22 years _____ months _____ days

Body to be shipped _____

Styl of Grave Vault _____

Interment at _____

Lot or Grave No. _____ Sec No. _____

No date on this page
death
date on preceding page
OCT 10, 1918
death
date on following page
OCT 14, 1918

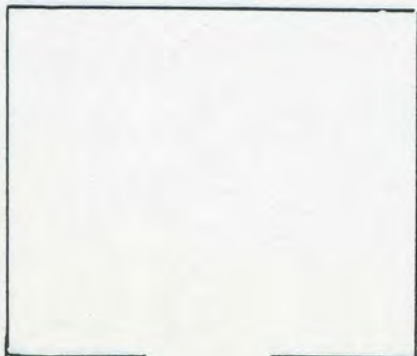

- 1 _____
- 2 _____
- 3 _____
- 4 _____
- 5 _____
- 6 _____

168

SCHUBERT MORTUARY BOOK
(Dec. 11, 1912 - Oct. 14, 1924)

Date _____

No. _____

NAME OF DECEASED BUNCE EWING

Charge to Mrs. LEWIS

Other Information

Order given by _____
How secured _____

The first name could be

Date of Funeral _____

BRUCE

Place of Death _____

Funeral Services at _____

Time of Funeral Service _____

Clergyman Rev Dobson

Physician _____

Number of Burial Certificate _____

Cause of Death Lobar Pneumonia

Date of Death OCT 14, 1918

Date of Birth _____

Occupation Soldier

Single or Married _____

Religion _____

Aged _____ years _____ months _____ days

Body to be shipped _____

Styl of Grave Vault _____

Interment at _____

Lot or Grave No. _____ Sec No. _____

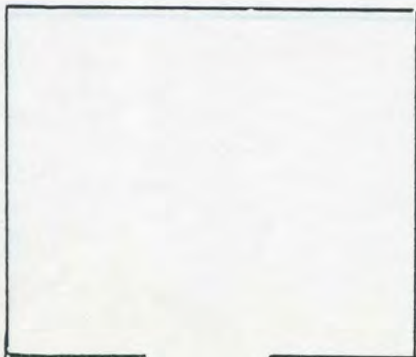

- 1 _____
- 2 _____
- 3 _____
- 4 _____
- 5 _____
- 6 _____

SCHUBERT MORTUARY BOCK
(Dec. 11, 1912 - Oct. 14, 1924)

Date OCT 18 1918

No. _____

NAME OF DECEASED GEO. AUG. KOEHLER

Charge to _____

Other Information

Order given by WILLIAM KOEHLER
How secured _____

Date of Funeral OCT 16 1918

Place of Death _____

Funeral Services at Cemetery

Time of Funeral Service 10 o'clock

Clergyman Rev. Stoerker

Physician J. G. Lee

Number of Burial Certificate _____

Cause of Death Pneumonia

Date of Death OCT 14 1918

Date of Birth _____

Occupation _____

Single or Married _____ Religion _____

Aged 2 years _____ months _____ days

Body to be shipped _____

Styl of Grave Vault _____

Interment at _____

Lot or Grave No. _____ Sec No. _____

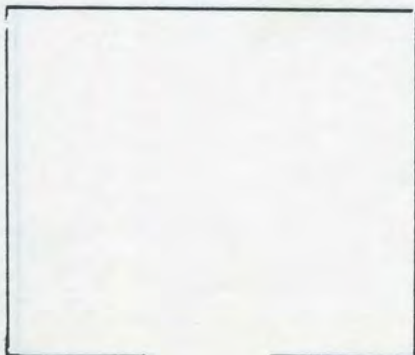

- 1 _____
- 2 _____
- 3 _____
- 4 _____
- 5 _____
- 6 _____

SCHUBERT MORTUARY BOOK
(Dec. 11, 1912 - Oct. 14, 1924)

Date OCT 18 1918

No. _____

NAME OF DECEASED W. H. ROBINSON

Charge to LIZZIE K. ROBINSON

Other Information

Order given by _____
How secured _____

(INDEX ADDS DR.) _____

Date of Funeral _____

Place of Death _____

Funeral Services at Home

Time of Funeral Service _____

Clergyman Rev. Barthel

Physician _____

Number of Burial Certificate _____

Cause of Death Blood Poisoning

Date of Death OCT 16 1918

Date of Birth _____

Occupation _____

Single or Married Married

Religion _____

Aged 72 years _____ months _____ days

Body to be shipped _____

Styl of Grave Vault _____

Interment at _____

Lot or Grave No. _____ Sec No. _____

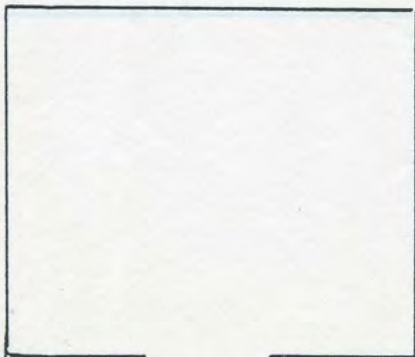

- 1 _____
- 2 _____
- 3 _____
- 4 _____
- 5 _____
- 6 _____

SCHUBERT MORTUARY BOOK
(Dec. 11, 1912 - Oct. 14, 1924)

Date Oct 21 1918

No. _____

NAME OF DECEASED SADIE WILLIAMS

Charge to _____

Other Information

Order given by JOHN WILLIAMS

How secured _____

Date of Funeral OCT 26 1918

Place of Death Eudora Kans.

Funeral Services at Home

Time of Funeral Service 2:30 P.M.

Clergyman O.W. Zeidler

Physician J.G. Lee

Number of Burial Certificate _____

Cause of Death Influenza

Date of Death OCT 20 1918

Date of Birth _____

Occupation Housewife

Single or Married Married

Religion _____

Aged 34 years _____ months _____ days

Body to be shipped _____

Styl of Grave Vault _____

Interment at _____

Lot or Grave No. _____ Sec No. _____

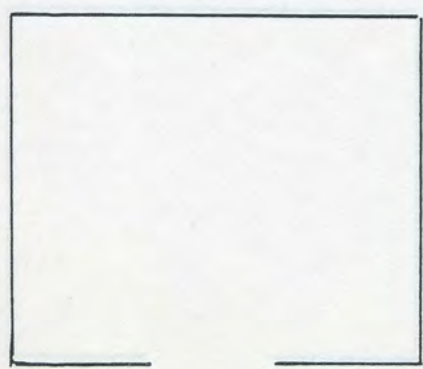

- 1 _____
- 2 _____
- 3 _____
- 4 _____
- 5 _____
- 6 _____

SCHUBERT MORTUARY BOOK
(Dec. 11, 1912 - Oct. 14, 1924)

Date OCT 23 1918

No. _____

NAME OF DECEASED PAUL LAWSON

Charge to SPENZER LAWSON

Other Information

Order given by _____

How secured _____

Date of Funeral OCT 26 * 1918

Place of Death Leavenworth Fort

Funeral Services at Home

Time of Funeral Service 10 a.m.

Clergyman Rev. STOERKER

Physician _____

* date was a
OCT. 5 with a 6 over it
ora 6 with a 5 over it

Number of Burial Certificate _____

Cause of Death Pneumonia

Date of Death OCT 21 1918

Date of Birth _____

Occupation Soldier

Single or Married Single Religion _____

Aged 21 years _____ months _____ days

Body to be shipped _____

Styl of Grave Vault _____

Interment at _____

Lot or Grave No. _____ Sec No. _____

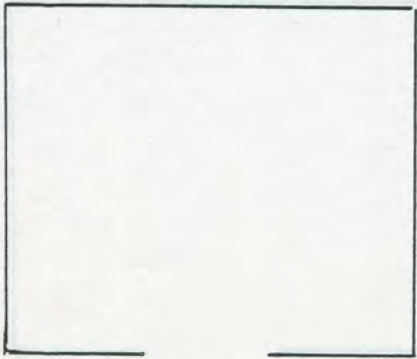

- 1 _____
- 2 _____
- 3 _____
- 4 _____
- 5 _____
- 6 _____

SCHUBERT MORTUARY BOOK
(Dec. 11, 1912 - Oct. 14, 1924)

Date OCT 24 1918

No. _____

NAME OF DECEASED Mrs FREIDA M. KONMEIER

Charge to Mr. KONMEIER

Other Information

Order given by _____

How secured _____

Date of Funeral OCT 25 1918

Place of Death _____

Funeral Services at Home

Time of Funeral Service 1 PM

* age was written over

Clergyman Rev STOERKER

Could be 24 or 34

Physician H. E. VanNoy

Number of Burial Certificate _____

Cause of Death Pneumonia

Date of Death OCT 23 1918

Date of Birth _____

Occupation Housewife

Single or Married Married

Religion _____

Aged 7 years _____ months _____ days

Body to be shipped FRANKLIN C. MO.

Styl of Grave Vault _____

Interment at _____

Lot or Grave No. _____ Sec No. _____

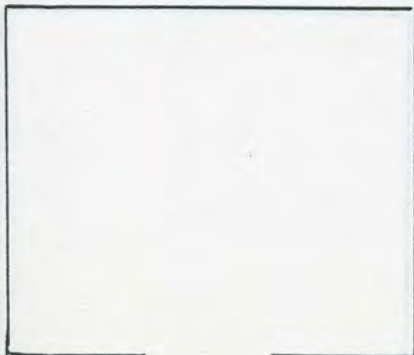

- 1 _____
- 2 _____
- 3 _____
- 4 _____
- 5 _____
- 6 _____

SCHUBERT MORTUARY BOOK
(Dec. 11, 1912 - Oct. 14, 1924)

✓ 174

Date Nov 20 1918

No. _____

NAME OF DECEASED Mrs. TRESSA DEAY GRIFFIN

Charge to EUGENE GRIFFIN

Other Information

Order given by _____
How secured _____

wife of

Date of Funeral Nov 24th

EUGENE GRIFFIN

Place of Death 5 1/2 miles south

Funeral Services at Home

Time of Funeral Service 2 P.M.

Clergyman O. W. Zeidler

Physician C. B. Miller

Number of Burial Certificate _____

Cause of Death _____

Date of Death Nov 20

Date of Birth _____

Occupation Housewife

Single or Married Married

Religion _____

Aged 27 years _____ months _____ days

Body to be shipped _____

Styl of Grave Vault _____

Interment at DEAY

Lot or Grave No. _____ Sec. No. _____

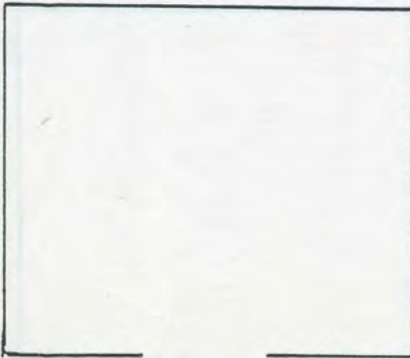

- 1 _____
- 2 _____
- 3 _____
- 4 _____
- 5 _____
- 6 _____

SCHUBERT MORTUARY BOCK
(Dec. 11, 1912 - Oct. 14, 1924)

Date Dec 2 1918

No. _____

NAME OF DECEASED ALICE FLORA CRUMBINE

Charge to MAY AMBLER

Other Information

Order given by _____
How secured _____

Date of Funeral Dec 2

Place of Death 6 mi S East

Funeral Services at Hesper

Time of Funeral Service 2 PM

Clergyman A. J. Bales

Physician C. B. Miller

Number of Burial Certificate _____

Cause of Death Acute Nephritis

Date of Death Nov 30

Date of Birth Aug. 8, 1873

Occupation Asst. House Keeper

Single or Married Single Religion _____

Aged 45 years 3 months 22 days

Body to be shipped _____

Styl of Grave Vault _____

Interment at Hesper Cem.

Lot or Grave No. _____ Sec No. _____

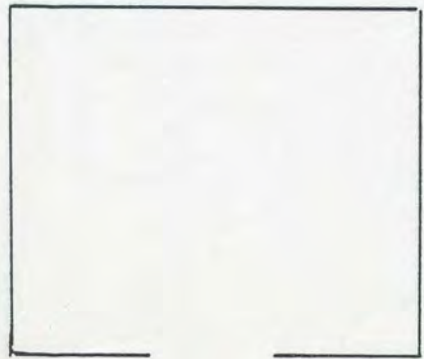

- 1 _____
- 2 _____
- 3 _____
- 4 _____
- 5 _____
- 6 _____